



POWERLINE® ULTRA SERIES

In-Line Mixed-Flow Fans

POWERLINE® ULTRA SERIES



All performance data shall be for a complete assembled unit based on ISO5801 or ANSI/AMCA 210-16 for air flow and BS848: Part 2, 1985 or ISO13347-3 for noise.

Ancillary Equipment

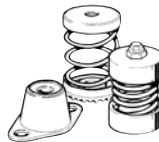

Vibration Isolators

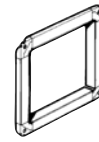

POW - Matching Flanges



FT - Mounting Foot

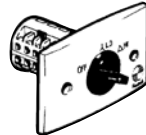

SD - Star/Delta switch



Variable speed drives



VA - Speed controller

Description

The PowerLine® Ultra Series of In-Line Mixed-Flow Fans is designed for a wide range of duct mounted applications. They are most suitable in commercial and industrial applications where medium pressure is required.

Typical Applications

Commercial and industrial supply or exhaust air applications such as shopping centres, office buildings, exhibition centres, hotels, health centres, schools and universities.

Features

- Robust, yet lightweight galvanised steel construction.
- Easy to fit 35mm TDF profile flange connections.
- To improve energy efficiency, motors can be speed-controlled.
- Can be mounted in any position.
- A range of matched ancillaries is also available.

Construction

Galvanised steel housings with 35mm TDF profile flange connections.

Mixed-Flow impellers are made from high performance injection moulded composite plastic material.

Motor

Standard direct-drive motors.

Electricity supply - three-phase to suit a wide range of voltages and frequencies.

Bearings - sealed for life, ball.

Standard direct-drive motors can be single or multi-speed and can be speed-controlled using a variable speed drive.

Internal Thermal Protection

Optional extra on standard frame motors.

Testing

Airflow tests based on ISO5801 or ANSI/AMCA 210-16

Noise tests based on BS848:Part 2, 1985, or ISO13347-3

Suggested Specification

The duct mounted fans shall be of the In-line Mixed-Flow PowerLine® Ultra Series as designed and manufactured by Elta Fans and be of the model number shown on the schedule/drawing.

They shall include galvanised steel housings with 35mm TDF profile flange connections.

The Mixed-Flow impellers shall be made from high performance injected moulded composite plastic and driven by external rotor or standard direct-drive motors as nominated.

How To Order

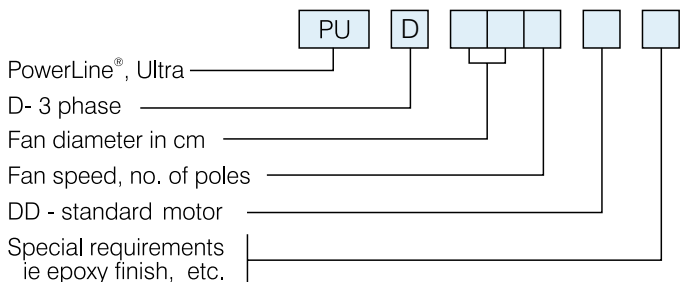

Note

Performance curves shown are based as-run speeds.

As motor speeds may vary from one manufacturer to another, and from one motor type to another, it is possible actual fan speeds may differ and, therefore, the performance of the fan.

Dimensions

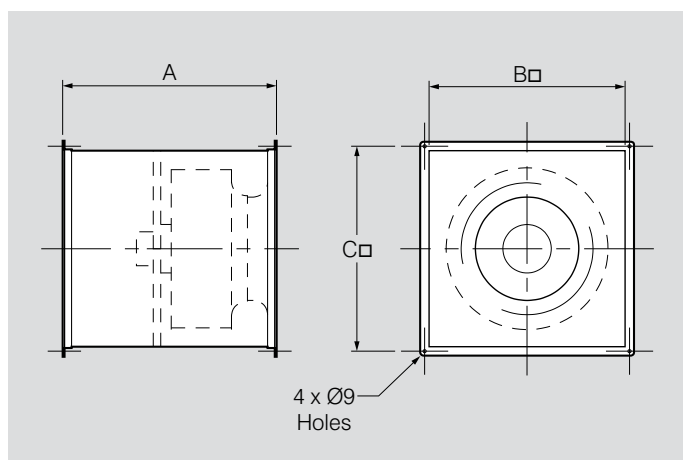

Model PUD..	Nominal dimensions, mm			App. wt. kg	App. vol. m ³
	A	B	C		
454	600	550	583	55	0.23
504	700	650	683	67	0.36

Technical Data & Noise Levels

Model PUD..	Nom. speed, rev/sec	Max. operating temp	PUD...		In-Duct Sound Power Levels, dB								
			avg. dB(A) @ 3m	PUD.. DD 3 ph. kW*	63	125	250	500	1k	2k	4k	8k	
454	24.19	60	Inlet	51	1.10	73	75	70	67	64	65	63	58
			Outlet	55		78	74	72	71	71	68	65	59
504	24.46	60	Inlet	56	2.2	77	81	76	71	70	69	66	61
			Outlet	60		85	81	82	73	76	72	67	60

* Amperages for standard TE motors can be obtained at time of order. Check fan nameplate for exact amperage of all motors.

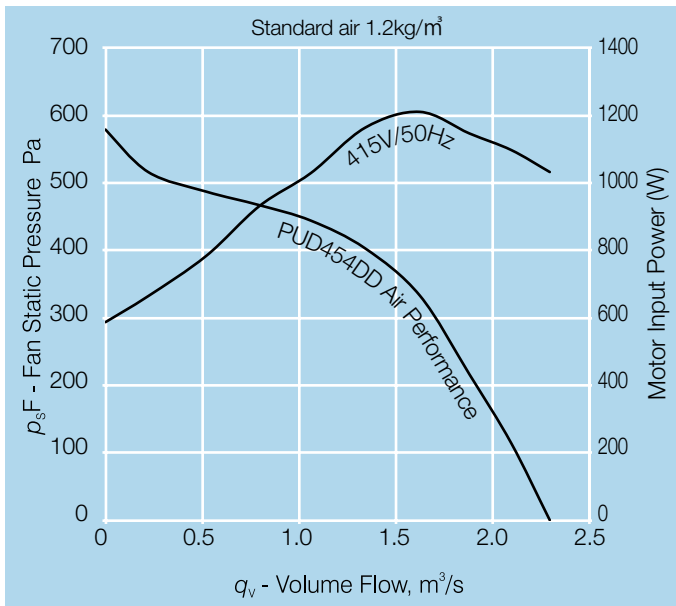

Elta Fans Malaysia Sdn. Bhd. certifies that the Powerline Ultra series of direct drive inline mixed flow fans shown herein are licensed to bear the AMCA seal.

The ratings shown are based on tests and procedures performed in accordance with AMCA Publication 211 and comply with the requirements of the AMCA Certified Ratings Programs. Performance certified is for installation type D: Ducted inlet, Ducted outlet.

Speed (RPS) shown is nominal. Performance is based on actual speed of test. Performance ratings do not include the effects of appurtenances (accessories).

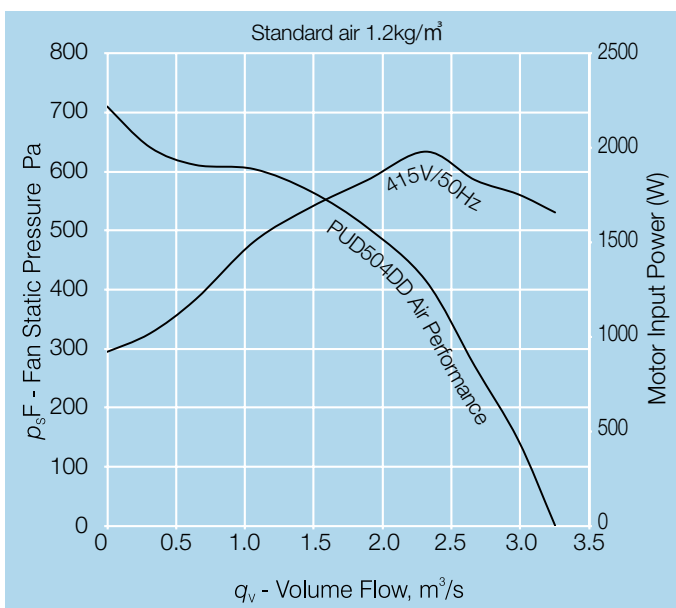



Elta Fans Malaysia Sdn Bhd

Tel **+603 7846 0340**

Fax **+603 7842 1132**

Email **info@eltafans.asia**

No. 147, Jalan TUDM Kampung
Baru Subang, 40150 Shah Alam,
Selangor West Malaysia, Malaysia

eltafans.asia

PUD..-January-2020 Issue A



FS 676456

A MEMBER OF  ELTA GROUP